

# ANSYS® Workbench™ Tutorial Release 14

Structural & Thermal Analysis Using  
the ANSYS Workbench Release 14  
Environment

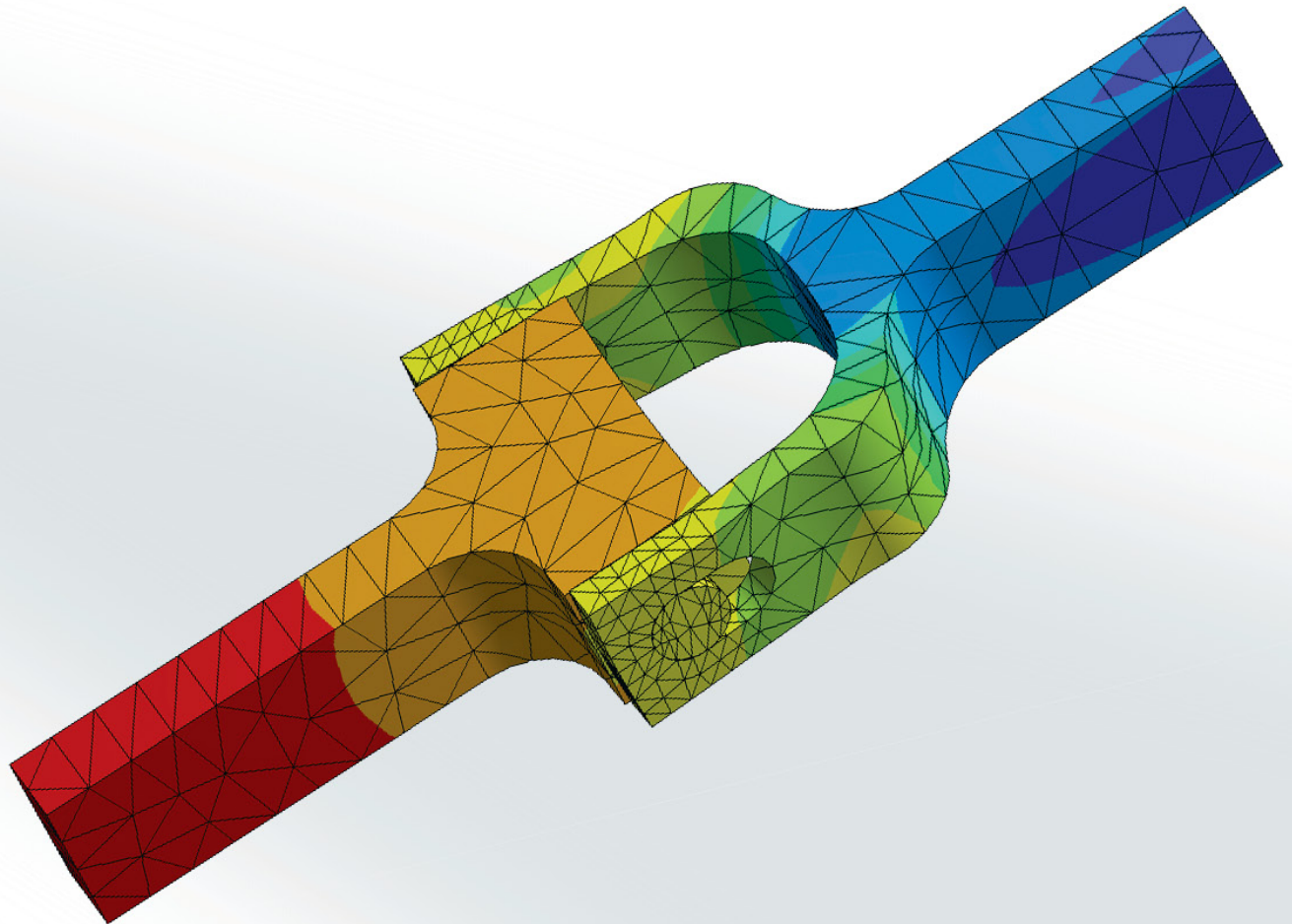

Kent L. Lawrence

Visit the following websites to learn more about this book:



[amazon.com](https://www.amazon.com)

[BARNES & NOBLE](https://www.barnesandnoble.com)

[Google books](https://books.google.com)

---

# CONTENTS

## INTRODUCTION

I-1 OVERVIEW	I-1
I-2 THE PROCESS	I-1
I-3 THE TUTORIALS	I-2
I-4 THE ANSYS WORKBENCH INTERFACE	I-3
I-5 THE ANSYS Workbench HELP SYSTEM	I-5
I-5 SUMMARY	I-8

## CHAPTER 1 – SOLID MODELING FUNDAMENTALS

1-1 OVERVIEW	1-1
1-2 INTRODUCTION	1-1
1-3 TUTORIAL 1A - EXTRUSION	1-2
1-4 TUTORIAL 1B – REVOLUTION	1-9
1-5 TUTORIAL 1C – SWEEP	1-11
1-6 SKETCHING	1-13
1-7 SUMMARY	1-16
1-8 PROBLEMS	1-17

## CHAPTER 2 – PLACED FEATURES, ASSEMBLY

2-1 OVERVIEW	2-1
2-2 INTRODUCTION	2-1
2-3 TUTORIAL 2A - ADDING A HOLE TO THE EXTRUSION	2-2
2-4 TUTORIAL 2B - ADDING A ROUND TO THE EXTRUSION	2-6
2-5 TUTORIAL 2C - ADDING A CHAMFER TO THE EXTRUSION	2-8
2-6 TUTORIAL 2D – PATTERNS	2-9
2-7 TUTORIAL 2E – CLEVIS ASSEMBLY	2-13
2-8 TUTORIAL 2F – ALTERNATE SOLID MODELER	2-18
2-9 SUMMARY	2-21
2-10 PROBLEMS	2-22

---

**CHAPTER 3 – MODELING TECHNIQUES**

3-1 OVERVIEW	3-1
3-2 INTRODUCTION	3-1
3-3 TUTORIAL 3A – PARAMETERS	3-2
3-4 OTHER CAD SYSTEMS	3-8
3-5 SURFACE AND LINE MODELS	3-9
3-6 TUTORIAL 3B – PLANAR SURFACE MODELS	3-9
3-7 TUTORIAL 3C – 3D SURFACE MODELS	3-11
3-8 TUTORIAL 3D – LINE BODY MODELS	3-12
3-9 SUMMARY	3-18
3-10 PROBLEMS	3-18

**CHAPTER 4 – ANSYS MECHANICAL I**

4-1 OVERVIEW	4-1
4-2 INTRODUCTION	4-1
4-3 TUTORIAL 4A – PLATE WITH CENTRAL CIRCULAR HOLE	4-2
4-4 TUTORIAL 4B – PLATE WITH CENTRAL SQUARE HOLE	4-23
4-5 SUMMARY	4-34
4-6 PROBLEMS	4-35

**CHAPTER 5 - ANSYS MECHANICAL II**

5-1 OVERVIEW	5-1
5-2 INTRODUCTION	5-1
5-3 TUTORIAL 5A – CYLINDRICAL PRESSURE VESSEL	5-1
5-4 TUTORIAL 5B - BRACKET	5-12
5-5 TUTORIAL 5C – CLEVIS ASSEMBLY	5-17
5-6 SUMMARY	5-25
5-7 PROBLEMS	5-26

---

---

**CHAPTER 6 – WIZARDS & TOOLS**

6-1 OVERVIEW	6-1
6-2 INTRODUCTION	6-1
6-3 TUTORIAL 6A – STATIC LOADINGS – DUCTILE MATERIALS	6-1
6-4 TUTORIAL 6B - STATIC LOADINGS – BRITTLE MATERIALS	6-10
6-5 TUTORIAL 6C - FATIGUE LOADINGS – DUCTILE MATERIALS	6-15
6-6 SUMMARY	6-23
6-7 PROBLEMS	6-23

**CHAPTER 7 – HEAT TRANSFER & THERMAL STRESS**

7-1 OVERVIEW	7-1
7-2 INTRODUCTION	7-1
7-3 HEAT TRANSFER	7-1
7-4 TUTORIAL 7A – TEMPERATURE DISTRIBUTION IN A CYLINDER	7-2
7-5 THERMAL STRESS I	7-7
7-6 TUTORIAL 7B – UNIFORM TEMPERATURE CHANGE	7-8
7-7 THERMAL STRESS II	7-19
7-8 TUTORIAL 7C – THERMAL STRESS IN A CYLINDER	7-19
7-9 SUMMARY	7-25
7-10 PROBLEMS	7-26

**CHAPTER 8 – SURFACE & LINE MODELS**

8-1 OVERVIEW	8-1
8-2 INTRODUCTION	8-1
8-3 TUTORIAL 8A – SHEET WITH CIRCULAR HOLE – PLANE STRESS	8-2
8-4 TUTORIAL 8B – PRESSURE VESSEL	8-12
8-5 TUTORIAL 8C – BRACKET	8-17
8-6 TUTORIAL 8D – LINE-BODY MODEL	8-23
8-7 SUMMARY	8-28
8-8 PROBLEMS	8-29

---

**CHAPTER 9 – NATURAL FREQUENCIES & BUCKLING LOADS**

9-1 OVERVIEW	9-1
9-2 INTRODUCTION	9-1
9-3 TUTORIAL 9A – SIMPLY SUPPORTED BEAM FREQUENCIES	9-1
9-4 TUTORIAL 9B – NATURAL FREQUENCIES OF A CHIME	9-8
9-5 TUTORIAL 9C – NATURAL FREQUENCIES OF AN ASSEMBLY	9-14
9-6 BUCKLING LOADS	9-18
9-7 TUTORIAL 9D – FIXED-FREE COLUMN (FLAGPOLE)	9-18
9-8 TUTORIAL 9E – BUCKLING OF A PINNED-PINNED COLUMN	9-22
9-9 TUTORIAL 9F – BUCKLING OF A BUILT-UP STRUCTURE	9-27
9-10 SUMMARY	9-30
9-11 PROBLEMS	9-32

**CHAPTER 10 – NONLINEAR PROBLEMS**

10-1 OVERVIEW	10-1
10-2 INTRODUCTION	10-1
10-3 TUTORIAL 10A – CANTILEVER BEAM	10-1
10-4 TUTORIAL 10B – SNAP BUCKLING OF A CYLINDRICAL PANEL	10-10
10-5 TUTORIAL 10C – ELASTO-PLASTIC DEFORMATION OF A BEAM	10-18
10-6 INCOMPRESSIBLE MATERIALS	10-23
10-7 TUTORIAL 10D – HYPERELASTIC CYLINDER	10-23
10-8 SUMMARY	10-32
10-9 PROBLEMS	10-33

**REFERENCES**

---