

ANSYS[®] Workbench Tutorial

*Structural & Thermal Analysis
Using the
ANSYS Workbench Release 12.1 Environment*

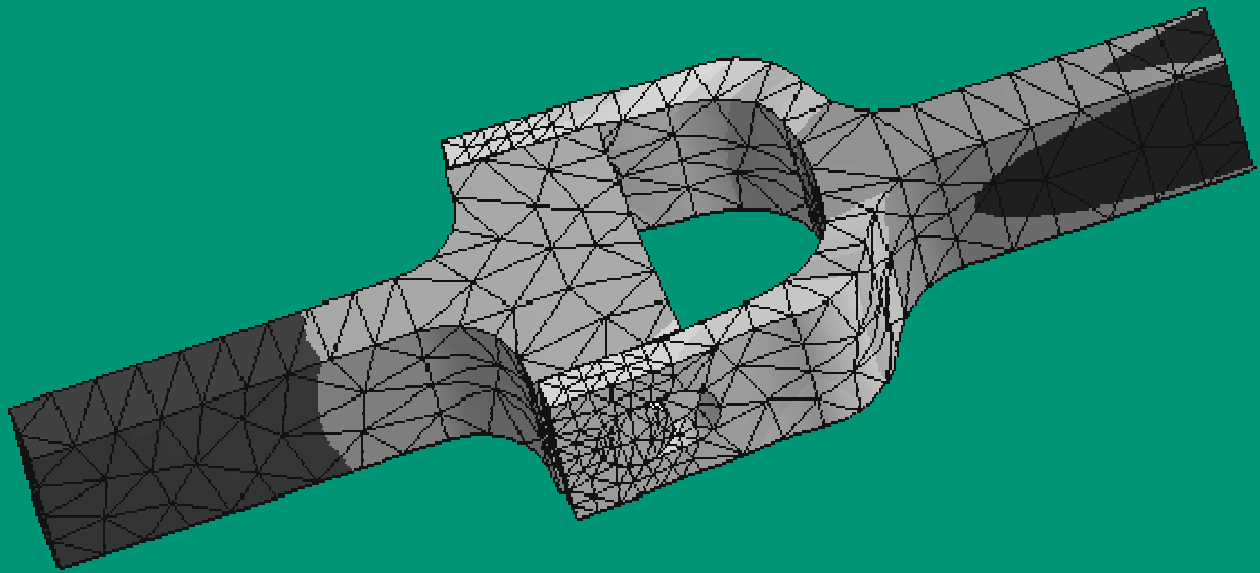

Kent L. Lawrence

Mechanical and Aerospace Engineering
University of Texas at Arlington

SDC
PUBLICATIONS

www.SDCpublications.com

Schroff Development Corporation

CONTENTS

INTRODUCTION

I-1 OVERVIEW	I-1
I-2 THE PROCESS	I-1
I-3 THE TUTORIALS	I-2
I-4 THE ANSYS WORKBENCH INTERFACE	I-3
I-5 SUMMARY	I-5

CHAPTER 1 – SOLID MODELING FUNDAMENTALS

1-1 OVERVIEW	1-1
1-2 INTRODUCTION	1-1
1-3 TUTORIAL 1A - EXTRUSION	1-2
1-4 TUTORIAL 1B – REVOLUTION	1-11
1-5 TUTORIAL 1C – SWEEP	1-14
1-6 SKETCHING	1-16
1-7 SUMMARY	1-20
1-8 PROBLEMS	1-20

CHAPTER 2 – PLACED FEATURES, ASSEMBLY

2-1 OVERVIEW	2-1
2-2 INTRODUCTION	2-1
2-3 TUTORIAL 2A - ADDING A HOLE TO THE EXTRUSION	2-2
2-4 TUTORIAL 2B - ADDING A ROUND TO THE EXTRUSION	2-6
2-5 TUTORIAL 2C - ADDING A CHAMFER TO THE EXTRUSION	2-8
2-6 TUTORIAL 2D – PATTERNS	2-9
2-7 TUTORIAL 2E – CLEVIS ASSEMBLY	2-13
2-8 TUTORIAL 2F – ALTERNATE SOLID MODELER	2-19
2-9 SUMMARY	2-20
2-10 PROBLEMS	2-21

CHAPTER 3 – MODELING TECHNIQUES

3-1 OVERVIEW	3-1
3-2 INTRODUCTION	3-1
3-3 TUTORIAL 3A – PARAMETERS	3-2
3-4 OTHER CAD SYSTEMS	3-9
3-5 SURFACE AND LINE MODELS	3-9
3-6 TUTORIAL 3B – PLANAR SURFACE MODELS	3-10
3-7 TUTORIAL 3C – 3D SURFACE MODELS	3-11
3-8 TUTORIAL 3D – LINE MODELS	3-13
3-9 SUMMARY	3-19
3-10 PROBLEMS	3-19

CHAPTER 4 – ANSYS MECHANICAL I

4-1 OVERVIEW	4-1
4-2 INTRODUCTION	4-1
4-3 TUTORIAL 4A – PLATE WITH CENTRAL CIRCULAR HOLE	4-2
4-4 TUTORIAL 4B – PLATE WITH CENTRAL SQUARE HOLE	4-21
4-5 SUMMARY	4-32
4-6 PROBLEMS	4-33

CHAPTER 5 - ANSYS MECHANICAL II

5-1 OVERVIEW	5-1
5-2 INTRODUCTION	5-1
5-3 TUTORIAL 5A – CYLINDRICAL PRESSURE VESSEL	5-1
5-4 TUTORIAL 5B - BRACKET	5-13
5-5 TUTORIAL 5C – CLEVIS ASSEMBLY	5-18
5-6 SUMMARY	5-27
5-7 PROBLEMS	5-28

CHAPTER 6 – WIZARDS & TOOLS

6-1 OVERVIEW	6-1
6-2 INTRODUCTION	6-1
6-3 TUTORIAL 6A – STATIC LOADINGS – DUCTILE MATERIALS	6-1
6-4 TUTORIAL 6B - STATIC LOADINGS – BRITTLE MATERIALS	6-12
6-5 TUTORIAL 6C - FATIGUE LOADINGS – DUCTILE MATERIALS	6-17
6-6 SUMMARY	6-23
6-7 PROBLEMS	6-24

CHAPTER 7 – HEAT TRANSFER & THERMAL STRESS

7-1 OVERVIEW	7-1
7-2 INTRODUCTION	7-1
7-3 HEAT TRANSFER	7-1
7-4 TUTORIAL 7A – TEMPERATURE DISTRIBUTION IN A CYLINDER	7-2
7-5 THERMAL STRESS I	7-8
7-6 TUTORIAL 7B – UNIFORM TEMPERATURE CHANGE	7-8
7-7 THERMAL STRESS II	7-19
7-8 TUTORIAL 7C – THERMAL STRESS IN A CYLINDER	7-20
7-9 SUMMARY	7-25
7-10 PROBLEMS	7-26

CHAPTER 8 – SURFACE & LINE MODELS

8-1 OVERVIEW	8-1
8-2 INTRODUCTION	8-1
8-3 TUTORIAL 8A – SHEET WITH CIRCULAR HOLE – PLANE STRESS	8-2
8-4 TUTORIAL 8B – PRESSURE VESSEL	8-13
8-5 TUTORIAL 8C – BRACKET	8-18
8-6 TUTORIAL 8D – LINE-BODY MODEL	8-24
8-7 SUMMARY	8-29
8-8 PROBLEMS	8-29

LESSON 9 – NATURAL FREQUENCIES & BUCKLING LOADS

9-1 OVERVIEW	9-1
9-2 INTRODUCTION	9-1
9-3 TUTORIAL 9A – SIMPLY SUPPORTED BEAM FREQUENCIES	9-1
9-4 TUTORIAL 9B – NATURAL FREQUENCIES OF A CHIME	9-9
9-5 TUTORIAL 9C – NATURAL FREQUENCIES OF AN ASSEMBLY	9-15
9-6 BUCKLING LOADS	9-20
9-7 TUTORIAL 9D – FIXED-FREE COLUMN (FLAGPOLE)	9-20
9-8 TUTORIAL 9E – BUCKLING OF A PINNED-PINNED COLUMN	9-24
9-9 TUTORIAL 9F – BUCKLING OF A BUILT-UP STRUCTURE	9-28
9-10 SUMMARY	9-32
9-11 PROBLEMS	9-33
