

# Residential Design using AutoCAD® 2010

Introduction to AutoCAD ♦ Hand Sketching ♦ Video Instruction

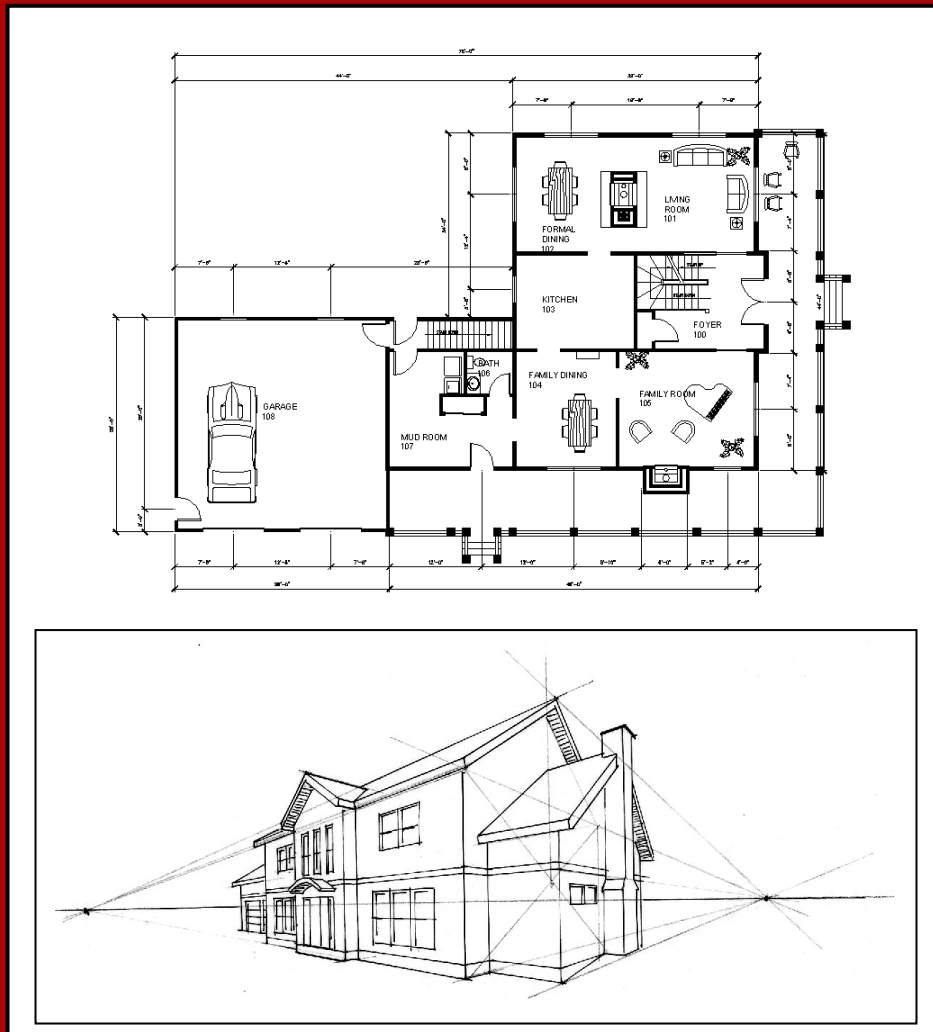

**Daniel John Stine**

**SDC**  
PUBLICATIONS

Schroff Development Corporation

[www.schroff.com](http://www.schroff.com)

INSIDE:



## Table of Contents

<b>INTRODUCTION – Sketching Exercises</b>		<b>Page</b>
I-1	Introduction	I-1
I-2	Freehand sketching from photos	I-8
I-3	Surveying and Sketching Objects	I-19
I-4	Sketching Floor Plans	I-23
I-5	Sketching Elevations – two point perspective	I-31
I-6	Sketching Elevations – one point perspective	I-47
I-7	Sketching Plans – one point perspective	I-55
<b>1.</b>	<b>Getting Started with AutoCAD 2010</b>	
1-1	What is AutoCAD 2010?	1-1
1-2	Overview of the AutoCAD 2010 User Interface	1-3
1-3	Open, Save & Close an Existing Drawing	1-12
1-4	Creating a New Drawing	1-16
1-5	Using Pan & Zoom to View Your Drawings	1-18
1-6	Using the AutoCAD Help System	1-24
	<i>Self-Exam &amp; Review Questions</i>	1-29
<b>2.</b>	<b>Crash Course Introduction (The Basics)</b>	
2-1	Lines and Shapes	2-1
2-2	Object Snaps	2-16
2-3	Modify Tools	2-21
2-4	Annotation	2-34
2-5	Printing	2-38
	<i>Self-Exam &amp; Review Questions</i>	2-42
<b>3.</b>	<b>Drawing Architectural Objects (Draw &amp; Modify)</b>	
3-1	Rectilinear Objects	3-1
3-2	Objects with Curves	3-9
3-3	Using Layers	3-30
	<i>Self-Exam &amp; Review Questions</i>	3-41
<b>4.</b>	<b>Residential Project: FLOOR PLANS</b>	
4-1	Walls	4-1
4-2	Doors	4-21
4-3	Windows	4-36
4-4	Annotation and Dimensions	4-42
	<i>Self-Exam &amp; Review Questions</i>	4-53
	<u>Additional Tasks</u>	
	Task 4-1 Fireplace (north)	4-54
	Task 4-2 Main Stairway	4-59
	Task 4-3 Secondary Stairway	4-60
	Task 4-4 Porch	4-61
	Task 4-5 Garage Steps	4-62
	Task 4-6 Fireplace (south)	4-62
<b>5.</b>	<b>Residential Project: EXTERIOR ELEVATIONS</b>	
5-1	Elevation outlines	5-1
5-2	Windows	5-18
5-3	Doors	5-29
5-4	Chimney, Railing and Siding	5-37
	<i>Self-Exam &amp; Review Questions</i>	5-52
	<u>Additional Tasks</u>	
	Task 5-1 Grade Line	5-53
	Task 5-2 Draw the other Chimney	5-55
	Task 5-3 Print content from a web site	5-56
	Task 5-4 Adding Foundation lines	5-56

	<b>Page</b>
<b>6. Residential Project: SECTIONS</b>	
6-1 Building Sections	6-1
6-2 Typical Wall Section	6-5
6-3 Adding Annotation to the Wall Section	6-9
6-4 Stair Section	6-13
<i>Self-Exam &amp; Review Questions</i>	6-23
<u>Additional Tasks</u>	
Task 6-1 Additional Building Sections	6-24
Task 6-2 Wall Section at Garage	6-24
Task 6-3 Hatch Wall Sections	6-24
Task 6-4 Stair Detail	6-25
<b>7. Residential Project: PLAN LAYOUT &amp; INTERIOR ELEVATIONS</b>	
7-1 Bathroom Layout	7-1
7-2 Bathroom Elevation	7-8
7-3 Adding Furnishings to your Floor Plans	7-21
7-4 Using Tool Palettes	7-27
<i>Self-Exam &amp; Review Questions</i>	7-38
<u>Additional Tasks</u>	
Task 7-1 Toilet Room Plan Layouts	7-39
Task 7-2 Toilet Room Elevations	7-39
Task 7-3 Furniture Layout	7-39
<b>8. Residential Project: SITE PLAN</b>	
8-1 Draw existing survey	8-1
8-2 Add House, Driveway and Walks	8-9
8-3 Layout New Contours	8-13
<i>Self-Exam &amp; Review Questions</i>	8-20
<u>Additional Tasks</u>	
Task 8-1 <i>Add items to the Site Plan</i>	8-21
Task 8-2 <i>Draw another grade profile</i>	8-21
Task 8-3 <i>Update grade profile for each exterior elev.</i>	8-21
<b>9. Residential Project: SCHEDULES &amp; SET UP SHEET</b>	
9-1 Room Finish Schedule	9-1
9-2 Sheet Setup & Management (Sheet Sets)	9-17
9-3 Sheet Index	9-44
<i>Self-Exam &amp; Review Questions</i>	9-52
<u>Additional Tasks</u>	
Task 9-1 <i>Create Door Schedule</i>	9-53
Task 9-2 <i>Place all your views on sheets</i>	9-53
Task 9-3 <i>Place callout bubbles on your sheets</i>	9-53
Task 9-4 <i>Add additional raster images to your drawing</i>	9-53
<b>10. Residential Project: LINEWEIGHTS &amp; PLOTTING</b>	
10-1 Lineweights	10-1
10-2 Plotting: Digital Set	10-12
10-3 Plotting: Hardcopy Set	10-25
<i>Self-Exam &amp; Review Questions</i>	10-35
<u>Additional Tasks</u>	
Task 10-1 <i>Apply lineweights to all your drawings</i>	10-36
Task 10-2 <i>Plot all your drawings full size</i>	10-36
Task 10-3 <i>Email a DWF file</i>	10-36
<b>Appendix A – Engineering Graphics</b>	
A-1 Introduction	A-1
A-2 Engineering Graphics	A-2
A-3 Orthographic Projection	A-11