

INSIDE:

MultiMedia CD



Engineering Design with SolidWorks 2008 and MultiMedia CD

A Step-by-Step Project Based Approach Utilizing 3D Solid Modeling

David C. Planchard & Marie P. Planchard, CSWP

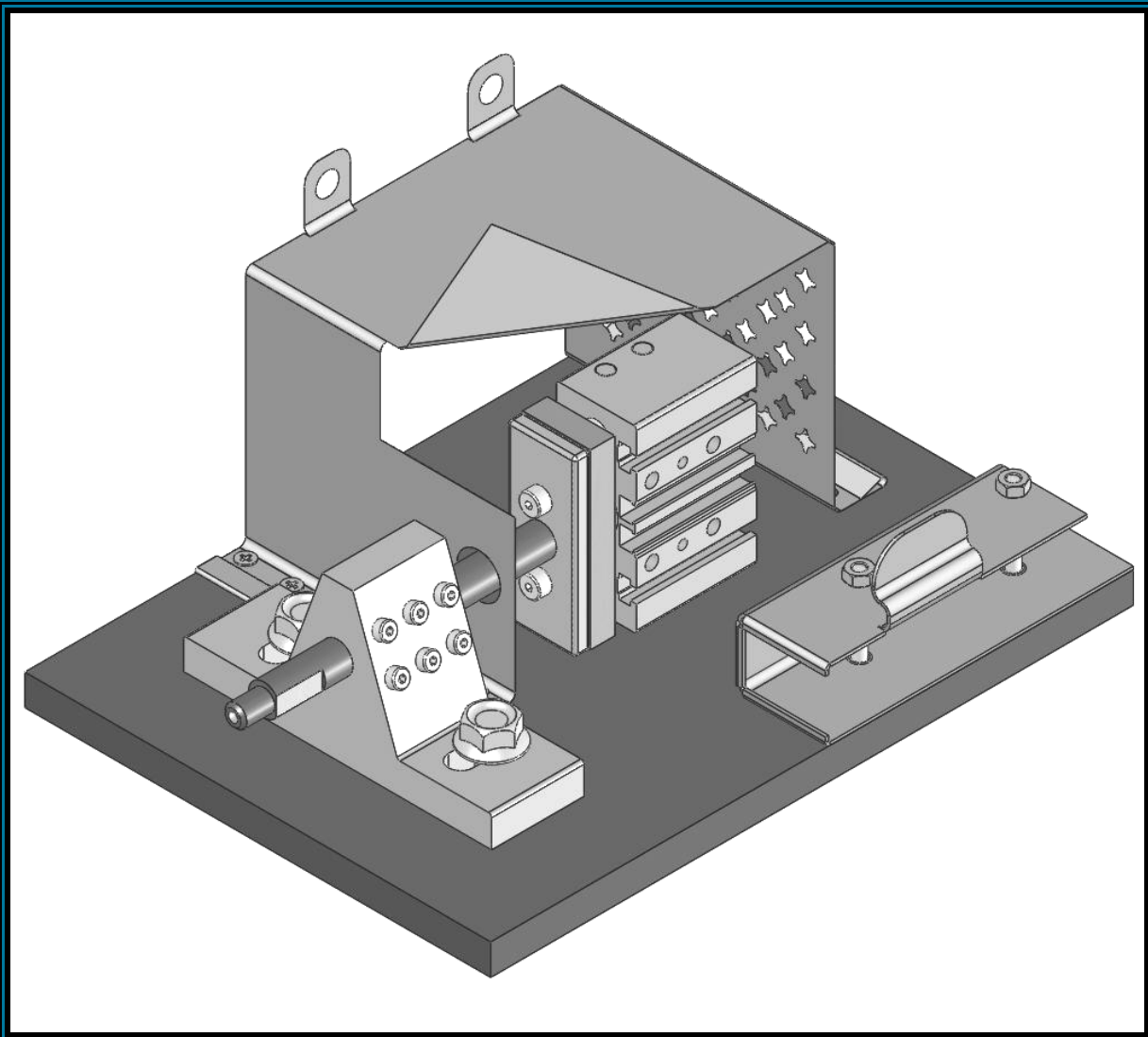

SDC
PUBLICATIONS

Schroff Development Corporation

www.schroff.com
www.schroff-europe.com



Table of Contents

Introduction	I-1
About the Cover	I-2
About the Authors	I-2
Dedication	I-3
Contact the Authors	I-3
Notes to Instructors	I-3
Trademarks, Disclaimer, and Copyrighted Material	I-3
References	I-4
Table of Contents	I-5
Overview of Projects	I-10
What is SolidWorks?	I-13
About the Book	I-15
Windows Terminology in SolidWorks	I-15
Project 1 – Fundamentals of Part Modeling	1-1
Project Objective	3
Project Situation	4
Project Overview	5
File Management	7
Start a SolidWorks Session	9
Understand the SolidWorks User Interface and CommandManager	10
Menu bar toolbar	10
Menu bar menu	10
Drop-down menu	11
Right-click Pop-up menus	11
Flyout tool buttons	11
System feedback icons	11
Confirmation Corner	12
Heads-up View toolbar	12
Default CommandManger	14
FeatureManager Design Tree	15
Fly-out FeatureManager	17
Task Pane	18
Design Library	18
File Explore	19
Search	19
View Palette	19
RealView	20
Document Recovery	20
Motion Study tab	20
System Options	26
Part Document Template and Document Properties	27
PLATE Part Overview	30
PLATE Part-New SolidWorks Document	32
PLATE Base Feature	33
Machined Part	33
Reference Planes and Orthographic Projection	35
PLATE Part-Extruded Base Feature	39

PLATE Part-Modify Dimensions and Rename	47
Display Modes, View Modes, View tools, and Appearances	49
Fasteners	51
PLATE Part-Extruded Cut Feature	52
PLATE Part-Fillet Feature	58
PLATE Part-Hole Wizard	60
ROD Part Overview	63
ROD Part-Extruded Base Feature	65
Rod Part-Extruded Cut Feature	67
ROD Part-Chamfer Feature	68
ROD Part-Extruded Cut Feature & Convert Entities Sketch Tool	69
ROD Part-View Orientation, Named Views & Viewport option	74
ROD Part-Copy/Paste Function	75
ROD Part-Design Changes with Rollback	76
ROD Part-Recover from Rebuild Errors	78
ROD Part-Edit Part Color	82
GUIDE Part Overview	84
GUIDE Part-Extruded Base Feature and Dynamic Mirror Feature	86
GUIDE Part-Extruded Cut Slot Profile	90
GUIDE Part-Mirror Feature	93
GUIDE Part-Holes	94
GUIDE PART-Linear Pattern Feature	97
GUIDE Part-Materials Editor and Mass Properties	99
Manufacturing Considerations	101
Sketch Entities and Sketch Tools	104
Project Summary	105
Project Terminology	105
Questions / Exercises	108
Project 2 – Fundamentals of Assembly Modeling	2-1
Project Objective	3
Project Situation	4
Project Overview	5
Bottom-Up Assembly Modeling approach	5
Linear Motion and Rotational Motion	6
GUIDE-ROD assembly	7
GUIDE-ROD assembly - Insert Components	12
FeatureManager Syntax	13
Mate Types	16
Standard Mates	16
Advanced Mates	17
Mechanical Mates	17
GUIDE-ROD Assembly-Mate the ROD Component	18
GUIDE-ROD Assembly-Mate the PLATE Component	23
GUIDE-ROD Assembly-Mate Errors	27
Collision Detection	30
Modify Component Dimension	31
Design Library	32
GUIDE-ROD Assembly- Inert Mates	35
Socket Head Cap Screw Part	39
SmartMates	44

Coincident/Concentric SmartMate	44
Tolerance and Fit	47
Exploded View	51
Section View	56
Analyze an Interference Problem	58
Save As Copy Option	59
GUIDE-ROD Assembly-Feature Driven Component Pattern	62
Redefining Mates and Linear Components Pattern	64
Folders and Suppressed Components	68
Make-Buy Decision: 3D ContentCentral	69
CUSTOMER Assembly	72
Copy the CUSTOMER Assembly	78
COSMOSXpress	81
Analyze the MGPMRod Part	86
Review of COSMOSXpress	91
Project Summary	92
Project Terminology	93
Questions / Exercises	96
Project 3 – Fundamentals of Drawing	3-1
Project Objective	3
Project Situation	4
Project Overview	4
Drawing Template and Sheet Format	5
Sheet Format and Title Block	12
Company Logo	17
Save Sheet Format and Save As Drawing Template	20
GUIDE Part-Modify	23
GUIDE Part-Drawing	24
Move Views and Properties of the Sheet	27
Auxiliary View, Section View and Detail View	30
Auxiliary View	31
Section View	32
Detail View	33
Display Modes and Performance	34
Detail Drawing	36
Move Dimensions in the Same View	39
Partial Auxiliary View-Crop View	41
Move Dimensions to a Different View	45
Dimension Holes and the Hole Callout	46
Center Marks and Centerlines	49
Modify the Dimension Scheme	51
GUIDE Part-Insert an Additional Feature	55
General Notes and Parametric Notes	57
Revision Table	60
Part Number and Document Properties	62
Exploded View	68
Balloons	70
Bill of Materials	72
Associative Part, Assembly, and Drawing	77
Project Summary	78

Project Terminology	79
Questions / Exercises	81
Project 4 – Extrude and Revolve Features	4-1
Project Objective	3
Project Overview	4
Design Intent	6
Project Situation	9
Part Template	11
BATTERY Part	15
BATTERY Part-Extruded Base Feature	17
BATTERY Part-Fillet Feature Edge	22
BATTERY Part-Extruded Cut Feature	24
BATTERY Part-Fillet Feature Face	26
BATTERY Part-Extruded Boss Feature	27
Injection Molded Process	33
BATTERYPLATE Part	34
Save As, Delete, Modify and Edit Feature	35
BATTERYPLATE Part-Extruded Boss Feature	37
BATTERYPLATE Part-Fillet Features-Full Round, options	38
Multibody Parts and the Extruded Boss Features	41
LENS Part	43
LENS Part-Revolved Base Feature	44
LENS Part-Shell Feature	47
Extruded Boss Feature and Convert Entities Sketch tool	48
LENS Part-Hole Wizard	49
LENS Part-Revolved Boss Thin Feature	52
LENS Part-Extruded Boss Feature and Offset Entities	54
LENS Part-Extruded Boss Feature and Transparent Optical Property	56
BULB Part	58
BULB Part-Revolved Base Feature	59
BULB Part-Revolved Boss Feature and Spline Sketch tool	61
BULB Part-Revolved Cut Thin Feature	63
BULB Part-Dome Feature	65
BULB Part-Circular Pattern Feature	66
Customizing Toolbars and Short Cut Keys	70
Design Checklist and Goals before Plastic Manufacturing	72
Mold Base	74
Applying SolidWorks Features for Mold Tooling Design	74
Manufacturing Design Issues	84
Project Summary	85
Project Terminology	86
Questions / Exercises	89
Project 5 – Swept, Loft, and Additional Features	5-1
Project Objective	3
Project Overview	4
Project Situation	5
O-RING Part- Swept Base Feature	7
O-RING Part-Design Table	9
SWITCH Part-Loft Base Feature	13

SWITCH Part-Shape Feature	18
Four Major Categories of Solid Features	20
LENSCAP Part	20
LENSCAP Part-Extruded Base, Extruded Cut and Shell Features	21
LENSCAP Part-Revolved Cut Thin Feature	24
LENSCAP Part-Thread, Swept Feature and Helix/Spiral Curve	25
HOUSING Part	31
HOUSING Part-Loft Boss Feature	34
HOUSING Part-First Extruded Boss Feature	38
HOUSING Part-Shell Feature	39
HOUSING Part-Second Extruded Boss Feature	40
HOUSING Part-Draft Feature	41
HOUSING Part-Thread with Swept Feature	43
HOUSING Part-Handle with Swept Feature	48
HOUSING Part-Extruded Cut Feature with Up To Surface	53
HOUSING Part-First Rib and Linear Pattern Feature	55
HOUSING Part-Second Rib Feature	58
HOUSING Part-Mirror Feature	61
FLASHLIGHT Assembly	64
Assembly Template	65
LENSANDBULB Sub-assembly	65
BATTERYANDPLATE Sub-assembly	70
CAPANLENS Sub-assembly	72
FLASHLIGHT assembly	76
Addressing Interference Issues	82
Export Files and eDrawings	83
Project Summary	86
Project Terminology	86
Questions / Exercises	87
Project 6 – Top Down Assembly Modeling	6-1
Project Objective	3
Project Situation	5
Top Down Design Approach	6
BOX Assembly Overview	8
InPlace Mates and In-Context features	10
Part Template and Assembly Template	12
Box Assembly and Layout Sketch	13
Link Values and Equations	17
MOTHERBOARD-Insert Component	20
POWERSUPPLY-Insert Component	26
Sheet Metal Overview	32
Bends	32
Relief	35
CABINET-Insert Component	35
CABINET-Rip Feature and Sheet Metal Bends	38
CABINET-Edge Flange	40
CABINET-Hole Wizard and Linear Pattern	43
CABINET-Sheetmetal Library Feature	47
CABINET-Louver Forming tool	51
Manufacturing Considerations	52

Additional Pattern Options	58
CABINET-Formed and Flat States	60
CABINET-Sheet Metal Drawing with Configurations	62
PEM Fasteners and IGES Components	68
Derived Component Pattern	72
MOTHERBOARD-Assembly Hole Feature	74
Assembly FeatureManager and External References	75
Replace Components	77
Equations	80
Design Table	84
BRACKET Part-Sheet Metal Features	87
BRACKET Part-In-Content Features	89
BRACKET Part-Edge, Tab, Break Corner, and Miter Features	91
BRACKET Part-Mirror Component	96
MirrorBRACKET Part-Bends, Fold, Unfold, and Jog Features	100
Project Summary	105
Project Terminology	106
Questions / Exercises	109

Appendix

ECO Form	A-1
Types of Decimal Dimensions (ASME Y14.5M)	A-2
SolidWorks Keyboard Shortcuts	A-3
Windows Shortcuts	A-3
CSWA Certification information	A-5
Intended audience	A-5
CSWA exam content	A-6
Why the CSWA exam	A-10
How to obtain the CSWA Certification	A-10
Exam day	A-11
What do I get when I pass	A-12
Helpful On-Line information	A-13

Index