

# **ANSYS<sup>®</sup> Workbench<sup>™</sup>** ***Tutorial***

***Structural & Thermal Analysis  
using the  
ANSYS Workbench Release 11.0 Environment***

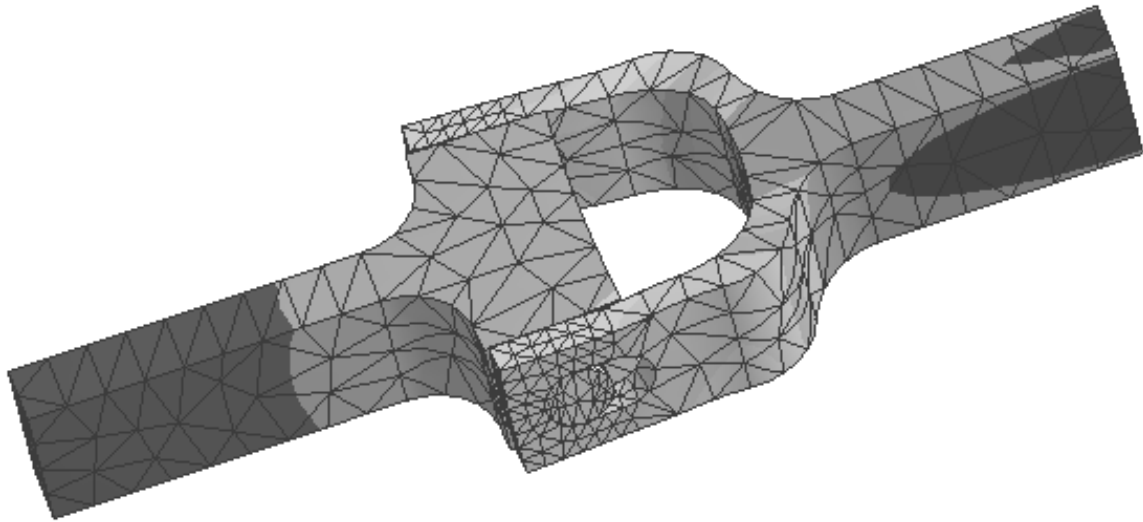

**Kent L. Lawrence**

Mechanical and Aerospace Engineering  
University of Texas at Arlington

**SDC**  
PUBLICATIONS

**Schroff Development Corporation**

---

**[www.schroff.com](http://www.schroff.com)**  
**[www.schroff-europe.com](http://www.schroff-europe.com)**

---

# **CONTENTS**

## **INTRODUCTION**

|                                   |     |
|-----------------------------------|-----|
| I-1 OVERVIEW                      | I-1 |
| I-2 THE PROCESS                   | I-1 |
| I-3 THE TUTORIALS                 | I-2 |
| I-4 THE ANSYS WORKBENCH INTERFACE | I-4 |
| I-5 SUMMARY                       | I-6 |

## **CHAPTER 1 – SOLID MODELING FUNDAMENTALS**

|                              |      |
|------------------------------|------|
| 1-1 OVERVIEW                 | 1-1  |
| 1-2 INTRODUCTION             | 1-1  |
| 1-3 TUTORIAL 1A - EXTRUSION  | 1-2  |
| 1-4 TUTORIAL 1B – REVOLUTION | 1-13 |
| 1-5 TUTORIAL 1C – SWEEP      | 1-16 |
| 1-6 SKETCHING                | 1-20 |
| 1-7 SUMMARY                  | 1-23 |
| 1-8 PROBLEMS                 | 1-23 |

## **CHAPTER 2 – PLACED FEATURES, ASSEMBLY**

|                                                     |      |
|-----------------------------------------------------|------|
| 2-1 OVERVIEW                                        | 2-1  |
| 2-2 INTRODUCTION                                    | 2-1  |
| 2-3 TUTORIAL 2A - ADDING A HOLE TO THE EXTRUSION    | 2-2  |
| 2-4 TUTORIAL 2B - ADDING A ROUND TO THE EXTRUSION   | 2-6  |
| 2-5 TUTORIAL 2C - ADDING A CHAMFER TO THE EXTRUSION | 2-8  |
| 2-6 TUTORIAL 2D – PATTERNS                          | 2-8  |
| 2-7 TUTORIAL 2E – CLEVIS ASSEMBLY                   | 2-13 |
| 2-8 TUTORIAL 2F – ALTERNATE SOLID MODELER           | 2-18 |
| 2-9 SUMMARY                                         | 2-19 |
| 2-10 PROBLEMS                                       | 2-20 |

---

**CHAPTER 3 – MODELING TECHNIQUES**

|                                         |      |
|-----------------------------------------|------|
| 3-1 OVERVIEW                            | 3-1  |
| 3-2 INTRODUCTION                        | 3-1  |
| 3-3 TUTORIAL 3A – PARAMETERS            | 3-2  |
| 3-4 OTHER CAD SYSTEMS                   | 3-9  |
| 3-5 SURFACE AND LINE MODELS             | 3-10 |
| 3-6 TUTORIAL 3B – PLANAR SURFACE MODELS | 3-10 |
| 3-7 TUTORIAL 3C – 3D SURFACE MODELS     | 3-11 |
| 3-8 TUTORIAL 3D – LINE MODELS           | 3-13 |
| 3-9 SUMMARY                             | 3-18 |
| 3-10 PROBLEMS                           | 3-19 |

**CHAPTER 4 – SIMULATION I**

|                                                    |      |
|----------------------------------------------------|------|
| 4-1 OVERVIEW                                       | 4-1  |
| 4-2 INTRODUCTION                                   | 4-1  |
| 4-3 TUTORIAL 4A – PLATE WITH CENTRAL CIRCULAR HOLE | 4-2  |
| 4-4 TUTORIAL 4B – PLATE WITH CENTRAL SQUARE HOLE   | 4-13 |
| 4-5 SUMMARY                                        | 4-26 |
| 4-6 PROBLEMS                                       | 4-27 |

**CHAPTER 5 - SIMULATION II**

|                                               |      |
|-----------------------------------------------|------|
| 5-1 OVERVIEW                                  | 5-1  |
| 5-2 INTRODUCTION                              | 5-1  |
| 5-3 TUTORIAL 5A – CYLINDRICAL PRESSURE VESSEL | 5-1  |
| 5-4 TUTORIAL 5B - BRACKET                     | 5-12 |
| 5-5 TUTORIAL 5C – CLEVIS ASSEMBLY             | 5-18 |
| 5-6 SUMMARY                                   | 5-27 |
| 5-7 PROBLEMS                                  | 5-27 |

---

---

**CHAPTER 6 – WIZARDS & TOOLS**

|                                                        |      |
|--------------------------------------------------------|------|
| 6-1 OVERVIEW                                           | 6-1  |
| 6-2 INTRODUCTION                                       | 6-1  |
| 6-3 TUTORIAL 6A – STATIC LOADINGS – DUCTILE MATERIALS  | 6-1  |
| 6-4 TUTORIAL 6B - STATIC LOADINGS – BRITTLE MATERIALS  | 6-12 |
| 6-5 TUTORIAL 6C - FATIGUE LOADINGS – DUCTILE MATERIALS | 6-16 |
| 6-6 SUMMARY                                            | 6-22 |
| 6-7 PROBLEMS                                           | 6-23 |

**CHAPTER 7 – HEAT TRANSFER & THERMAL STRESS**

|                                                          |      |
|----------------------------------------------------------|------|
| 7-1 OVERVIEW                                             | 7-1  |
| 7-2 INTRODUCTION                                         | 7-1  |
| 7-3 HEAT TRANSFER                                        | 7-1  |
| 7-4 TUTORIAL 7A – TEMPERATURE DISTRIBUTION IN A CYLINDER | 7-2  |
| 7-5 THERMAL STRESS I                                     | 7-8  |
| 7-6 TUTORIAL 7B – UNIFORM TEMPERATURE CHANGE             | 7-8  |
| 7-7 THERMAL STRESS II                                    | 7-19 |
| 7-8 TUTORIAL 7C – THERMAL STRESS IN A CYLINDER           | 7-19 |
| 7-9 SUMMARY                                              | 7-26 |
| 7-10 PROBLEMS                                            | 7-26 |

**CHAPTER 8 – SURFACE & LINE MODELS**

|                                                           |      |
|-----------------------------------------------------------|------|
| 8-1 OVERVIEW                                              | 8-1  |
| 8-2 INTRODUCTION                                          | 8-1  |
| 8-3 TUTORIAL 8A – SHEET WITH CIRCULAR HOLE – PLANE STRESS | 8-2  |
| 8-4 TUTORIAL 8B – PRESSURE VESSEL                         | 8-8  |
| 8-5 TUTORIAL 8C – BRACKET                                 | 8-12 |
| 8-6 TUTORIAL 8D – LINE-BODY MODEL                         | 8-19 |
| 8-7 SUMMARY                                               | 8-23 |
| 8-8 PROBLEMS                                              | 8-23 |

---

**LESSON 9 – NATURAL FREQUENCIES & BUCKLING LOADS**

|                                                      |      |
|------------------------------------------------------|------|
| 9-1 OVERVIEW                                         | 9-1  |
| 9-2 INTRODUCTION                                     | 9-1  |
| 9-3 TUTORIAL 9A – SIMPLY SUPPORTED BEAM FREQUENCIES  | 9-1  |
| 9-4 TUTORIAL 9B – NATURAL FREQUENCIES OF A CHIME     | 9-8  |
| 9-5 TUTORIAL 9C – NATURAL FREQUENCIES OF AN ASSEMBLY | 9-13 |
| 9-6 BUCKLING LOADS                                   | 9-18 |
| 9-7 TUTORIAL 9D – FIXED-FREE COLUMN (FLAGPOLE)       | 9-18 |
| 9-8 TUTORIAL 9E – BUCKLING OF A PINNED-PINNED COLUMN | 9-21 |
| 9-9 TUTORIAL 9F – BUCKLING OF A BUILT-UP STRUCTURE   | 9-23 |
| 9-10 SUMMARY                                         | 9-26 |
| 9-11 PROBLEMS                                        | 9-27 |

---