

INSIDE:

MultiMedia CD

An audio/visual
presentation of the
tutorial projects

Engineering Design with SolidWorks 2007

and MultiMedia CD

A Step-by-Step Project Based Approach Utilizing 3D Solid Modeling

David C. Planchard & Marie P. Planchard

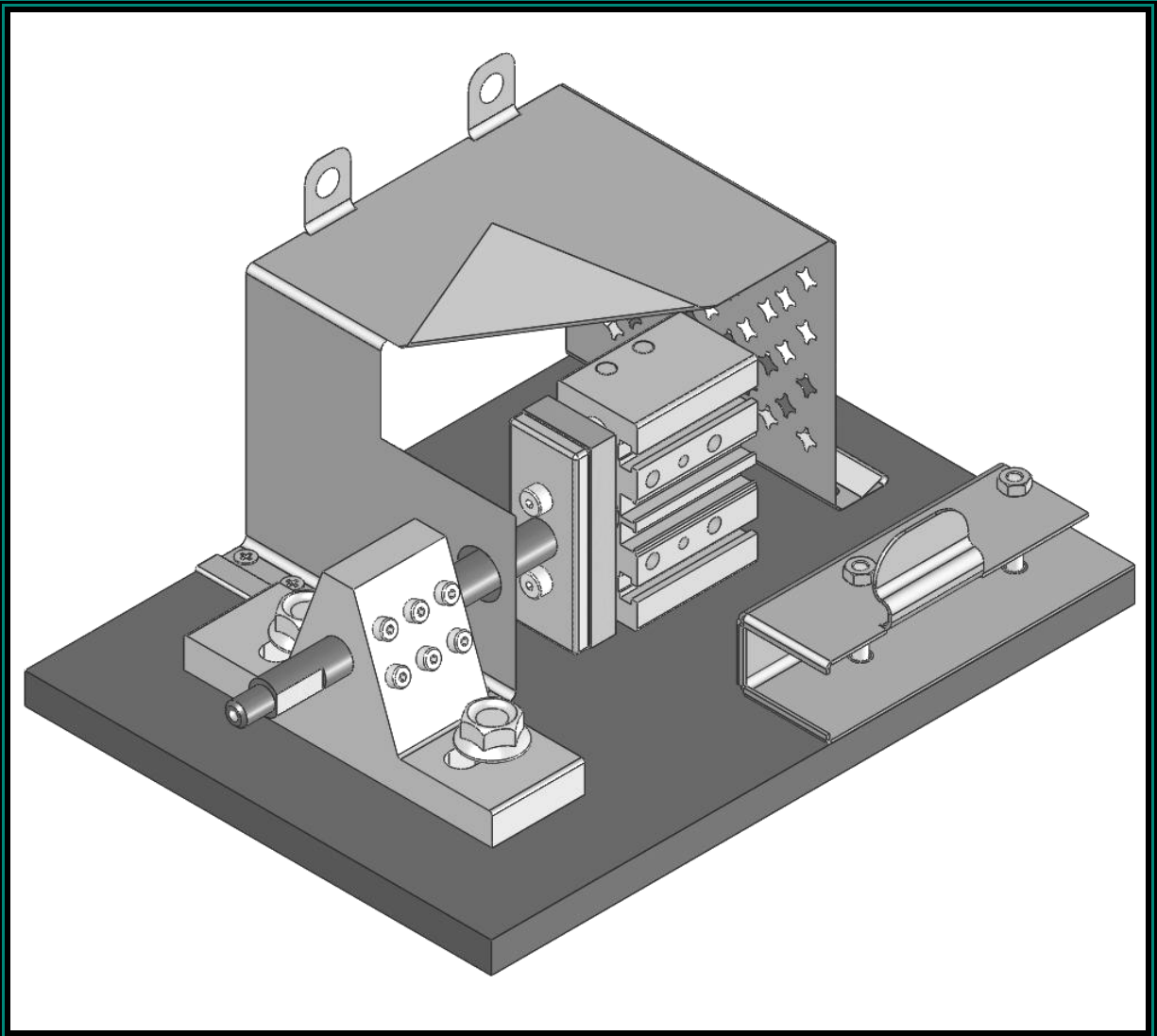

SDC
PUBLICATIONS

Schroff Development Corporation

www.schroff.com
www.schroff-europe.com

3D
SolidWorks

Solution
Partner

Table of Contents

Introduction	I-1
About the Cover	I-2
About the Authors	I-2
Dedication	I-3
Contact the Authors	I-3
Notes to Instructors	I-3
Trademarks, Disclaimer, and Copyrighted Material	I-3
References	I-4
Table of Contents	I-5
Overview of Projects	I-10
What is SolidWorks?	I-13
About the Book	I-15
Windows Terminology in SolidWorks	I-15
Project 1 – Fundamentals of Part Modeling	1-1
Project Objective	3
Project Situation	4
Project Overview	5
File Management	7
Start a SolidWorks Session	9
Design Library	10
File Explorer	11
Search	11
View Palette	11
Auto Recovery	12
PhotoWorks	12
Drop-Down Menu	12
Fly-out FeatureManager	12
Right-click Pop-up menu	13
FeatureManager design tree	13
Confirmation Corner	13
User Interface and CommandManager	13
System Options	19
Part Document Template and Document Properties	22
PLATE Part Overview	26
PLATE Part-New SolidWorks Document	28
PLATE Base Feature	29
Machined Part	29
Reference Planes and Orthographic Projection	31
PLATE Part-Extruded Base Feature	35
PLATE Part-Modify Dimensions and Rename	43
Display Modes, View Modes, and Viewport	45
Fasteners	47
View Orientation	48
PLATE Part-Extruded Cut Feature	49
PLATE Part-Fillet Feature	56
PLATE Part-Hole Wizard	58
ROD Part Overview	61

ROD Part-Extruded Base Feature	63
Rod Part-Extruded Cut Feature	65
ROD Part-Chamfer Feature	66
ROD Part-Extruded Cut Feature & Convert Entities Sketch Tool	67
ROD Part-View Orientation, Named Views & Viewport option	72
ROD Part-Copy/Paste Function	73
ROD Part-Design Changes with Rollback	75
ROD Part-Recover from Rebuild Errors	77
ROD Part-Edit Part Color	82
GUIDE Part Overview	84
GUIDE Part-Extruded Base Feature and Dynamic Mirror Feature	86
GUIDE Part-Extruded Cut Slot Profile	90
GUIDE Part-Mirror Feature	93
GUIDE Part-Holes	94
GUIDE PART-Linear Pattern Feature	97
GUIDE Part-Materials Editor and Mass Properties	99
Manufacturing Considerations	101
Sketch Entities and Sketch Tools	104
Project Summary	105
Project Terminology	105
Questions / Exercises	108

Project 2 – Fundamentals of Assembly Modeling **2-1**

Project Objective	3
Project Situation	4
Project Overview	5
Bottom-Up Assembly Modeling approach	5
Linear Motion and Rotational Motion	6
GUIDE-ROD assembly	7
GUIDE-ROD assembly - Insert Components	12
FeatureManager Syntax	14
Mate Types	16
GUIDE-ROD Assembly-Mate the ROD Component	19
GUIDE-ROD Assembly-Mate the PLATE Component	22
GUIDE-ROD Assembly-Mate Errors	27
Collision Detection	30
Modify Component Dimension	31
Design Library	32
Inert Mates	35
Socket Head Cap Screw Part	39
SmartMates	44
Coincident/Concentric SmartMate	44
Tolerance and Fit	47
Exploded View	51
Section View	56
Analyze an Interference Problem	58
Save As Copy Option	59
GUIDE-ROD Assembly-Component Pattern	62
Redefining Mates and Linear Components Pattern	64
Folders and Suppressed Components	68
Make-Buy Decision: 3D ContentCentral	69

CUSTOMER Assembly	72
Copy the CUSTOMER Assembly	80
COSMOSXpress	82
Analyze the MGPMRod Part	86
Review of COSMOSXpress	93
Project Summary	93
Project Terminology	94
Questions / Exercises	97
Project 3 – Fundamentals of Drawing	3-1
Project Objective	3
Project Situation	4
Project Overview	4
Drawing Template and Sheet Format	5
Sheet Format and Title Block	12
Company Logo	17
Save Sheet Format and Save As Drawing Template	20
GUIDE Part-Modify	23
GUIDE Part-Drawing	24
Move Views and Properties of the Sheet	27
Auxiliary View, Section View and Detail View	30
Auxiliary View	31
Section View	32
Detail View	33
Display Modes and Performance	34
Detail Drawing	36
Move Dimensions in the Same View	39
Partial Auxiliary View-Crop View	41
Move Dimensions to a Different View	45
Dimension Holes and the Hole Callout	46
Center Marks and Centerlines	49
Modify the Dimension Scheme	51
GUIDE Part-Insert an Additional Feature	55
General Notes and Parametric Notes	57
Revision Table	60
Part Number and Document Properties	62
Exploded View	68
Balloons	70
Bill of Materials	72
Associative Part, Assembly, and Drawing	77
Project Summary	78
Project Terminology	79
Questions / Exercises	81
Project 4 – Extrude and Revolve Features	4-1
Project Objective	3
Project Overview	4
Design Intent	6
Project Situation	10
Part Template	12

BATTERY Part	16
BATTERY Part-Extruded Base Feature	18
BATTERY Part-Fillet Feature Edge	23
BATTERY Part-Extruded Cut Feature	25
BATTERY Part-Fillet Feature Face	27
BATTERY Part-Extruded Boss Feature	28
Injection Molded Process	34
BATTERYPLATE Part	35
Save As, Delete, Modify and Edit Feature	36
BATTERYPLATE Part-Extruded Boss Feature	38
BATTERYPLATE Part-Fillet Features-Full Round, options	39
Multibody Parts and the Extruded Boss Features	42
LENS Part	44
LENS Part-Revolved Base Feature	45
LENS Part-Shell Feature	48
Extruded Boss Feature and Convert Entities Sketch tool	49
LENS Part-Hole Wizard	50
LENS Part-Revolved Boss Thin Feature	53
LENS Part-Extruded Boss Feature and Offset Entities	55
LENS Part-Extruded Boss Feature and Transparent Optical Property	57
BULB Part	59
BULB Part-Revolved Base Feature	60
BULB Part-Revolved Boss Feature and Spline Sketch tool	62
BULB Part-Revolved Cut Thin Feature	64
BULB Part-Dome Feature	66
BULB Part-Circular Pattern Feature	67
Customizing Toolbars and Short Cut Keys	71
Design Checklist and Goals before Plastic Manufacturing	73
Mold Base	75
Applying SolidWorks Features for Mold Tooling Design	75
Manufacturing Design Issues	85
Project Summary	86
Project Terminology	87
Questions / Exercises	90
Project 5 – Sweep, Loft and Additional Features	5-1
Project Objective	3
Project Overview	4
Project Situation	5
O-RING Part- Sweep Base Feature	7
O-RING Part-Design Table	9
SWITCH Part-Loft Base Feature	13
SWITCH Part-Shape Feature	18
Four Major Categories of Solid Features	20
LENSCAP Part	20
LENSCAP Part-Extruded Base, Extruded Cut and Shell Features	21
LENSCAP Part-Revolved Cut Thin Feature	24
LENSCAP Part-Thread, Sweep Feature and Helix/Spiral Curve	25
HOUSING Part	31
HOUSING Part-Loft Boss Feature	34
HOUSING Part-First Extruded Boss Feature	38

HOUSING Part-Shell Feature	39
HOUSING Part-Second Extruded Boss Feature	40
HOUSING Part-Draft Feature	41
HOUSING Part-Thread with Sweep Feature	43
HOUSING Part-Handle with Sweep Feature	48
HOUSING Part-Extruded Cut Feature with Up To Surface	53
HOUSING Part-First Rib and Linear Pattern Feature	54
HOUSING Part-Second Rib Feature	58
HOUSING Part-Mirror Feature	61
FLASHLIGHT Assembly	64
Assembly Template	66
LENSANDBULB Sub-assembly	67
BATTERYANDPLATE Sub-assembly	70
CAPANLENS Sub-assembly	72
FLASHLIGHT assembly	76
Addressing Interference Issues	82
Export Files and eDrawings	83
Project Summary	86
Project Terminology	86
Questions / Exercises	87
Project 6 – Top Down Assembly Modeling	6-1
Project Objective	3
Project Situation	5
Top Down Design Approach	6
BOX Assembly Overview	8
InPlace Mates and In-Context features	10
Part Template and Assembly Template	12
Box Assembly and Layout Sketch	13
Link Values and Equations	17
MOTHERBOARD-Insert Component	20
POWERSUPPLY-Insert Component	26
Sheet Metal Overview	32
Bends	32
Relief	35
CABINET-Insert Component	35
CABINET-Rip Feature and Sheet Metal Bends	38
CABINET-Edge Flange	40
CABINET-Hole Wizard and Linear Pattern	43
CABINET-Sheetmetal Library Feature	47
CABINET-Louver Forming tool	51
Manufacturing Considerations	52
Additional Pattern Options	58
CABINET-Formed and Flat States	60
CABINET-Sheet Metal Drawing with Configurations	62
PEM Fasteners and IGES Components	68
Derived Component Pattern	72
MOTHERBOARD-Assembly Hole Feature	74
Assembly FeatureManager and External References	75
Replace Components	77
Equations	80

Design Table	84
BRACKET Part-Sheet Metal Features	87
BRACKET Part-In-Content Features	89
BRACKET Part-Edge, Tab, Break Corner, and Miter Features	91
BRACKET Part-Mirror Component	96
MirrorBRACKET Part-Bends, Fold, Unfold, and Jog Features	100
Project Summary	105
Project Terminology	106
Questions / Exercises	109

Appendix

ECO Form	A-1
Types of Decimal Dimensions (ASME Y14.5M)	A-2
Cursor Feedback	A-3
Sketch Tools	A-3
Sketching Relations	A-4
Dimensions	A-4
Selection, (edge, body, etc.)	A-5
Assemblies	A-6
SmartMates	A-6
FeatureManager	A-6
Drawings	A-7
Standard Tools	A-7
SolidWorks Keyboard Shortcuts	A-8
Windows Shortcuts	A-9
Helpful On-Line Information	A-10

Index